

说明书/INSTRUCTIONS

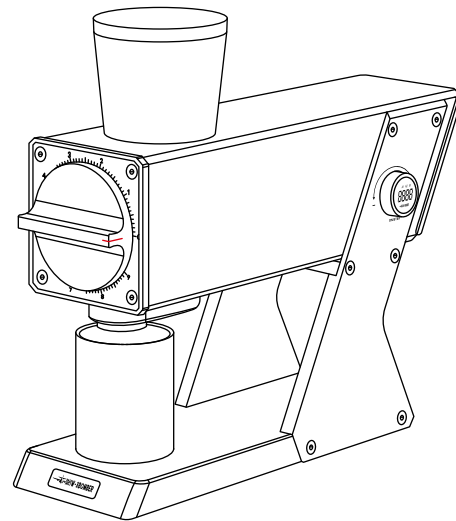

 **MHW-3BOMBER**® 航海家F74磨豆机

F74 Navigator Electric Grinder

 @MHW_3BOMBER

 info@mhw3bomber.com

 @MHW-3BOMBER

 WWW.MHW3BOMBER.COM

产品部件及配件

① 磨豆机 ② 磁吸接粉罐 ③ 电源线 ④ 实木毛刷 ⑤ 产品资料

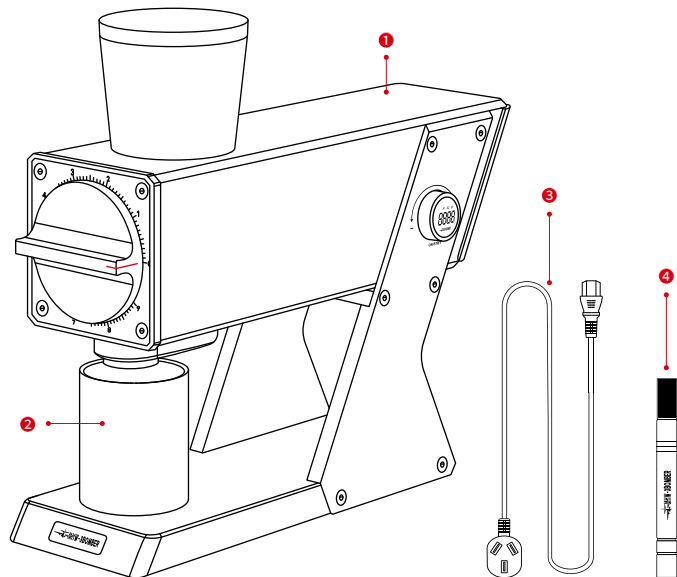

产品结构图

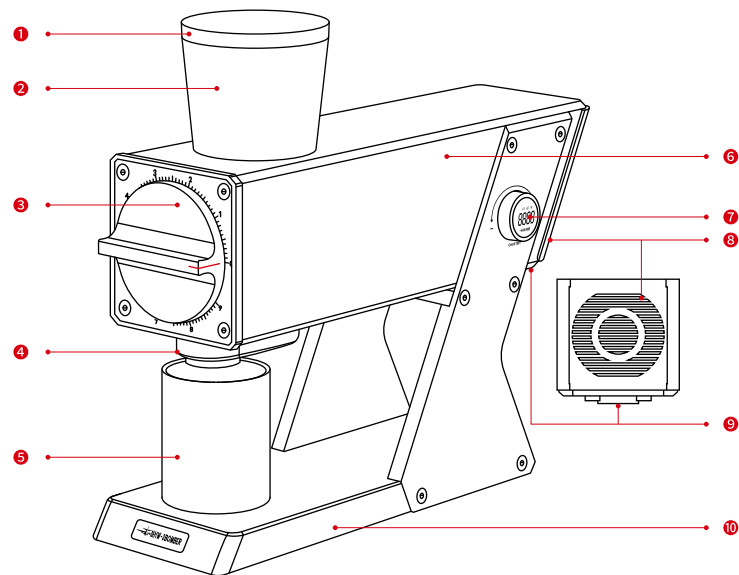

① 豆仓盖 ② 豆仓 ③ 研磨度调节盘 ④ 出粉口/等离子模块 ⑤ 磁吸接粉罐
⑥ 机身 ⑦ 启停开关/模式选择/转速调节 ⑧ 散热口 ⑨ 电源插口 ⑩ 底座

调试前

- ① 将磨豆机从包装中取出;
- ② 检查磨豆机或者配件是否损坏;
- ③ 如有损坏请勿使用, 立即联系品牌方。

使用前的准备事项

- ① 请拆除磨豆机的外包装, 取出所有配件, 仔细阅读说明书;
- ② 请使用干净柔软的半干毛巾擦净机身表面并彻底晾干。

安装并连接磨豆机

- ① 将磨豆机放置于平整、稳固和无震动的平面并正确连接电源;
- ② 确保豆仓正确插入磨豆机机身导轨;
(安全防误触装置: 需正确锁好豆仓, 才能启动设备)
- ③ 将电源插头插入按规定安装的插座中。

磨豆机使用方法

本设备会将倒入的咖啡豆一次性研磨完毕, 使用前请称量好所需咖啡豆, 一次性倒入磨豆机进行研磨。
研磨时请保持机身平放, 盖好豆仓盖。

① 调节研磨度

将粉罐置于底座磁吸定位。
(出粉口正下方)
调节研磨度转盘至想要的研磨度。
(具体请参考"研磨刻度调节"说明)

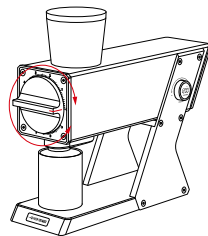

② 启动磨豆机

按下启停开关, 让机器进入启动状态。

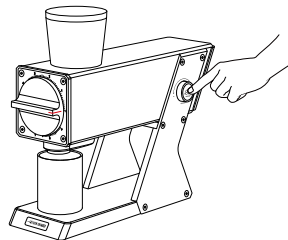

3 倒入咖啡豆

将称量好的咖啡豆倒入豆仓。
入豆后请盖上豆仓盖。

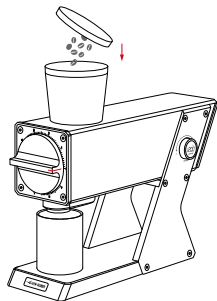

4 研磨完成

研磨过程中可随时按下启停按钮来
暂停研磨,研磨完成后,可手动或自
动(自动模式下)停止研磨并待机。

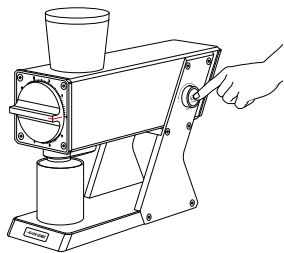

*磨豆机无操作,待机30分钟数码旋钮自动息屏,再次开启即可

*为了确保等离子除静电防飞粉效果,建议每研磨20次,及时清洁出粉口

研磨刻度调节

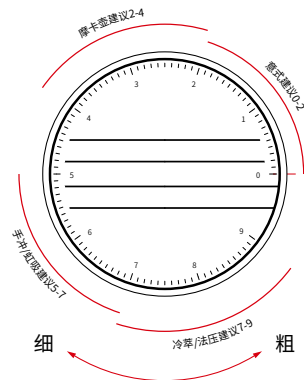

◆ 本设备有90格研磨刻度,可根据所需自行调节。通过调节环上的红线对应研磨刻度。

◆ 调节数值越小,研磨的咖啡粉越细,调节数值越大,研磨咖啡粉越粗。

研磨度推荐



意式
建议 0-2



摩卡壶
建议 2-4



手冲/虹吸
建议 5-7



冷萃/法压
建议 7-9

旋钮功能

研磨转速设定：



功能旋钮

- ◆ 设备开启状态下，顺时针增加转速，逆时针降低转速，转数800-1600RPM，调整精度为100RPM。
- ◆ 本设备支持手动调节刀盘转速，可以根据个人习惯和咖啡豆特性等设置不同转速，拓展可玩性，体验更多咖啡萃取的乐趣。
- ◆ 转速调节旋钮位于机身侧面
- ◆ 研磨烘焙度较浅或质地较硬的咖啡豆时，请勿将转速设置得过低以防卡豆。(建议转速1000RPM以上)

模式设定：



- ◆ 待机模式下，长按2秒进入模式设定，使用旋钮进行模式选择。



- ◆ A1-自动反转模式：单击旋钮开启设备，投入咖啡豆，自动识别咖啡豆研磨完成后，反转3S后进入待机。



- ◆ A2-自动无反转模式：单击旋钮开启设备，投入咖啡豆，自动识别咖啡豆研磨完成后，进入待机。



- ◆ M-手动模式：单击旋钮开启设备，投入咖啡豆，研磨完成后，单击旋钮关闭设备，进入待机。

***3种模式下，磨豆机持续研磨1分钟后自动停止**

刀盘校准调节

本章节操作说明仅供专业人士参考。需要拆卸设备相关部件，详细教学请参考官方调节视频或联系专业人员指导下进行，由个人拆装行为带来的损坏，品牌方对此不承担任何责任。

1

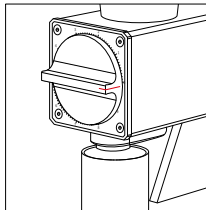

调节刻度归零

2

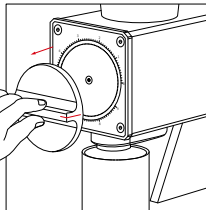

取下研磨度调节盘

3

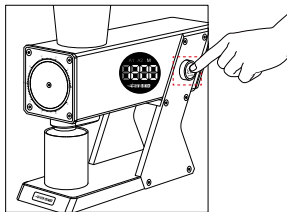

打开磨豆机调至手动模式，保证磨豆机一直处于工作状态

4

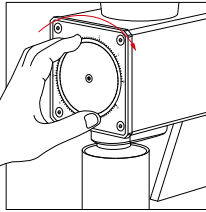

顺时针缓慢旋转齿轮，直至听到轻微的刀盘摩擦声，立刻停止旋转

关于研磨刀盘

本设备使用自研74mm的平刀,可实现全域研磨,充分适配各类咖啡制作方式。可实现高均匀度细粉集中的研磨状态,让咖啡粉获得相对理想的萃取。

刀盘采用420不锈钢材质、镀钛工艺,拥有极高的耐磨性,保证了研磨效果和机器的长久使用寿命。

日常清理/注意事项

- ① 研磨后可用毛刷清理豆仓与出粉口;
- ② 请勿对机身任何部位进行水洗;
- ③ 接粉罐底部带有磁性,请勿将其放置电子秤上,以免损坏电子秤;
- ④ 本设备仅为研磨咖啡豆使用,请勿研磨其它产品;
- ⑤ 如长时间使用后发热明显,可待设备冷却后再行使用;
- ⑥ 设备运作期间,严禁将物体或手指放入豆仓;
- ⑦ 磨芯边缘较为锋利,请注意以免划伤;
- ⑧ 请勿让儿童接触和操作本产品;
- ⑨ 磨豆机为精密设备,如需拆卸刀盘及相关部件,请联系客服或在专业人员指导下进行,由个人拆卸带来的损坏,品牌方对此不承担责任;
- ⑩ 如果电源线破损或损坏,请立即停止使用。务必使用原装电源线或制造商指定电源线进行更换。

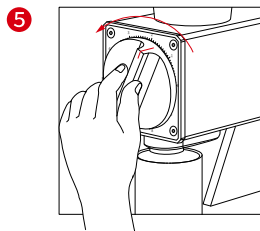

装上调节盘,然后逆时针
回退约18格刻度

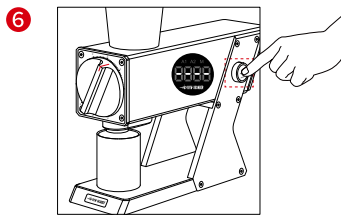

关掉磨豆机

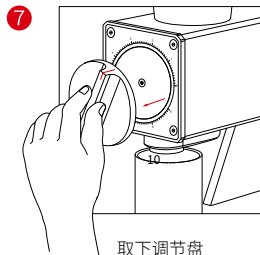

取下调节盘

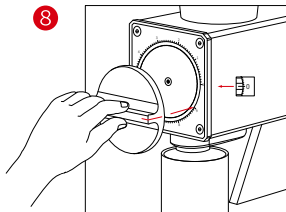

红色标线对准0刻度线放回
调节盘

*随着刀盘的使用磨损回退格数会发生变化

故障排除

故障代码	故障代码解释	解决方法
E1	转速低于100转	重新启动机器
E2	电机堵转	调节更粗的研磨或更高转速后重启机器

*研磨浅烘焙咖啡豆时请设定转速>1000转/分钟。
*出现以上问题或任何其他问题均可联系轰炸机售后客服协助进行处理。

产品信息

品牌		额定功率	400W
品名	航海家F74磨豆机	额定频率	50Hz/60Hz
产品尺寸	325mm×109mm×284mm	豆仓容量	约50g
产品净重	7.4kg	接粉杯容量	约50g
额定电压	220V~/220-240V~/120V~	质保期	一年

售后保修卡

感谢您购买MHW-3BOMBER品牌产品，产品如无私自拆卸或人为损伤，凭此保修卡可享受由购买日起为期1年的免费维修服务。

保修条例

以下情况不属于免费保修范围：

- 未按说明书规定操作，维护，保管，自行拆卸等人为因素而造成的损坏；
- 使用不当，意外疏忽(摔落等)造成的损坏；
- 因不可抗力因素(如雷电，地震，火灾，水灾等)造成损坏。

维护信息

产品名称及型号 _____

购买时间 _____

购买方式 _____

订单编号 _____

客户姓名 _____

联系方式 _____

退货原因 _____

售后登记

☐ 维修 ☐ 换货 ☐ 退货

合格证

本产品经检验符合质量标准要求 检验员: _____

电话: 400-9922-092

合格

02





维修记录

修理日期	故障情况	维修结果

关于我们

咖啡卓越的美学, 让我们不断创新设计来进一步完善, 每一件作品都来源于咖啡与生活的碰撞, 专业只是其一, 传递积极向上的正能量才是我们的根本。

如有任何疑问请与我们联系

 轰炸机咖啡设备制造(中山)有限公司
 中山市小榄镇宝丰社区友诚路3号
 400-9922-092
 WWW.MHW3BOMBER.COM



更多资讯关注官方公众号

PRODUCT COMPONENTS AND ACCESSORIES

- 1 Grinder
- 2 Magnetic Dosing Cup
- 3 Power Cord
- 4 Wooden Brush
- 5 Product Documentation

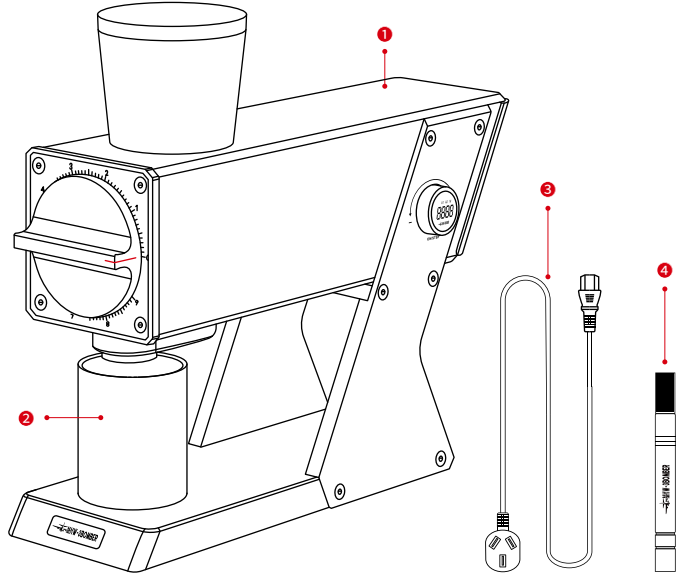

PRODUCT STRUCTURE DIAGRAM

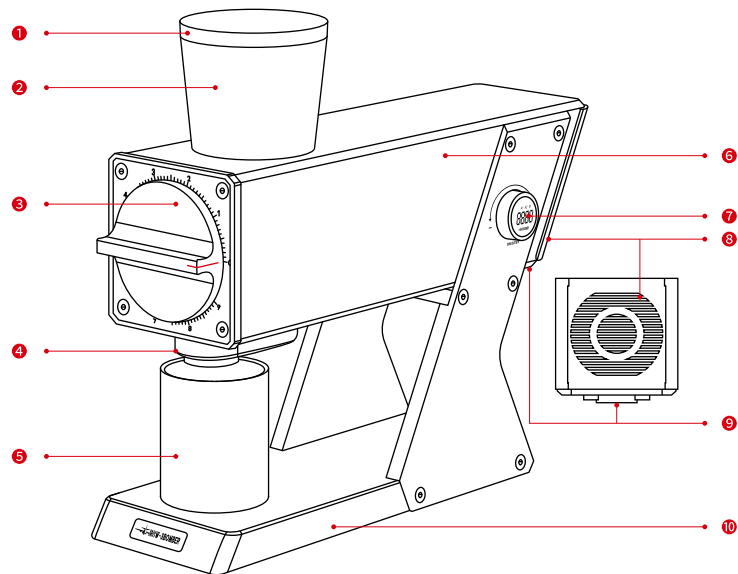

- ① Bean Hopper Lid ② Bean Hopper ③ Grind Size Adjustment Dial ④ Powder Outlet / Plasma Module
⑤ Magnetic Dosing Cup ⑥ Machine Body of F74 Navigator Electric Grinder
⑦ Power Button/ Mode Selection / Grind Speed Adjustment ⑧ Cooling Vent ⑨ Power Socket ⑩ Base

BEFORE SETUP

- ① Remove the grinder from the packaging;
- ② Check if the grinder or any accessories are damaged;
- ③ Please do not use, If any damage is discovered. Contact the MHW-3BOMBER.

BEFORE USE

- ① Remove the outer packaging of the grinder, take out all accessories, and carefully read the user manual;
- ② Wipe the machine's surface with a clean, soft, slightly damp cloth and allow it to dry completely.

INSTALLATION AND CONNECTION

- ① Place the grinder on a flat, stable, and vibration-free surface, and connect it properly to the power source;
- ② Ensure the bean hopper is correctly inserted into the machine;
(Safety Lock Feature: The machine will only start when the bean hopper is properly locked.)
- ③ Plug into a properly installed socket.

HOW TO USE

This product will grind the coffee beans completely in one go. Please measure the required amount of coffee beans and pour them into the grinder at once. Keep the grinder flat during grinding and ensure the bean hopper lid is securely closed.

1 Adjust the Grind Size

Place the dosing cup on the base, aligning it with the magnetic position. (directly below the grounds outlet)
Turn the grind adjustment dial to the desired grind size.
(Refer to the "Grind Size Adjustment" section for details.)

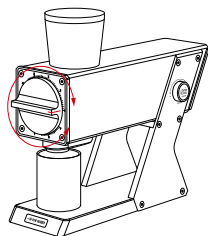

2 Start the Grinder

Press the start/stop button to activate the machine.

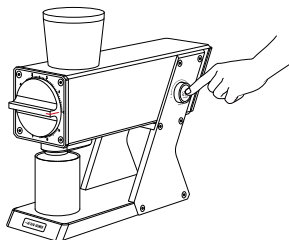

3 Add Coffee Beans

Pour the measured coffee beans into the hopper, secure the hopper lid.

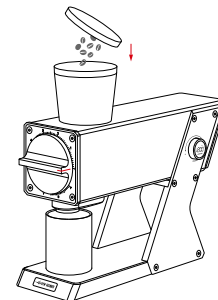

4 Control Grinding

You can press the power button at any time during grinding to pause the process. Once grinding is complete, the machine will stop automatically (auto mode) or manually.

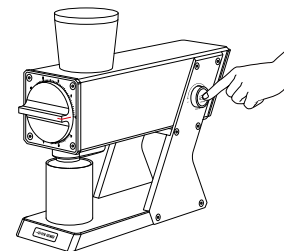

*To maintain effective plasma anti-static, clean the powder outlet every 20 grinding sessions advised.

*If the machine remains standby for 30 minutes, the digital knob will automatically turn off, simply restart it to reactivate.

GRINDING SETTING

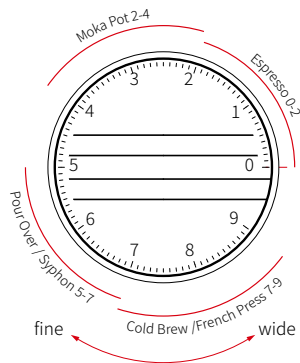

◆ F74 Navigator Electric Grinder features 90 grind scale marking that can be adjusted as needed. The grind size is adjusted using the red line on the adjustment ring to align with the desired setting.

◆ Smaller value setting grinds finer coffee grounds, while larger setting produces coarser grounds.

GRIND SIZE RECOMENDATION



Espresso
0-2



Moka Pot
2-4



Pour Over
Syphon
5-7



Cold Brew
French Press
7-9

KNOB FUNCTION

Grinding speed setting:



Function knob

◆ When the machine is in use, turn clockwise to increase the speed, turn counterclockwise to decrease the speed, and the range is 800 - 1600 rpm.

◆ This machine allows manual adjustment of the burr speed, enabling customization based on personal preferences and coffee bean characteristics, offering a more enjoyable coffee extraction experience.

◆ The speed adjustment knob is located on the side of the machine.

◆ When grinding lightly roasted or harder coffee beans, avoid setting the speed too low to prevent clogging (recommended speed: above 1000 RPM).

Mode setting:



◆ In standby mode, press and hold for 2 seconds to enter mode selection.



◆ A1 – Auto Reverse

Press the knob to start the grinder, add coffee beans, and the machine will automatically detect once the grinding completes. And it will reverse for 3 seconds before entering standby mode.



◆ A2 – Auto Non-Reverse

Press the knob to start the grinder, add coffee beans, and the machine will automatically detect once the grinding completes, then enter standby mode.



◆ M – Manual

Press the knob to start the device, add coffee beans. After grinding is complete, press the knob again to stop the grinder and enter standby mode.

***The grinder will automatically stop after 1 minute of continuous grinding.**

BURR CALIBRATION ADJUSTMENT

This section is for professional reference only. Disassembling relevant parts of the device should only be done by professionals. For detailed guidance, please refer to the official adjustment video or contact a professional for assistance. The brand is not responsible for any damage caused by unauthorized disassembly.

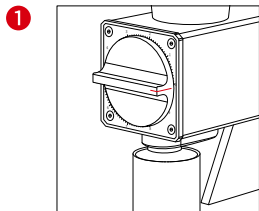

Set the scale to zero

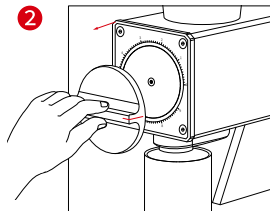

Remove the grind size adjustment dial

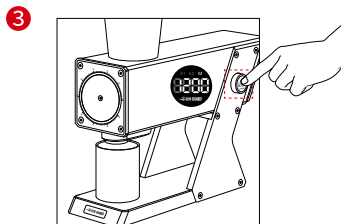

Set the grinder to manual mode and ensure it stays in operation

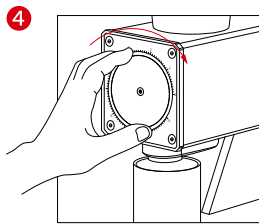

Slowly rotate the burrs clockwise until you hear a slight grinding sound, then immediately stop rotating

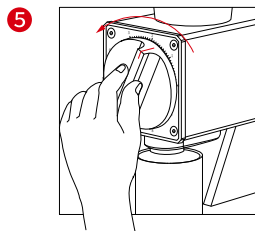

Reattach the grind size adjustment dial, then rotate it counterclockwise back by about 18 clicks

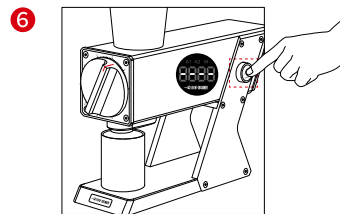

Turn off the grinder

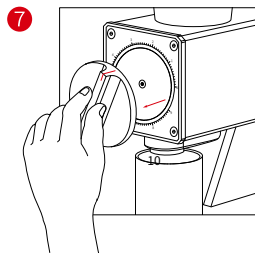

Remove the grind size adjustment dial

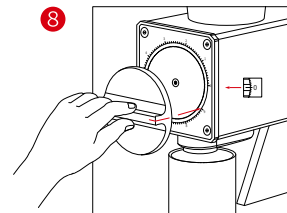

Align the red marker with the 0 scale line and reattach the grind size adjustment dial

***As the burrs wear over time, the number of clicks for adjustment may change.**

ABOUT THE GRINDING BURRS

This device is equipped with a self-developed 74mm flat burrs, designed for versatile grinding, fully adaptable to various coffee brewing methods. It achieves high uniformity in fine coffee grounds, ensuring the coffee grounds are ideal for extraction.

The burrs are made of 420 stainless steel and treated with titanium coating, offering excellent wear resistance to ensure optimal grinding performance and long-lasting durability.

CLEANING AND PRECAUTIONS

- ① After grinding, use a brush to clean the bean hopper and powder outlet;
- ② Do not wash any part of the machine with water;
- ③ The bottom of the dosing cup is magnetic. Please do not place it on an electronic scale to avoid any damage;
- ④ This device is designed only for grinding coffee beans. Do not grind anything else;
- ⑤ If the machine heats up significantly after prolonged use, please allow it to cool down before using again;
- ⑥ Never place objects or fingers into the bean hopper while the grinder is working;
- ⑦ The burrs are sharp, do handle with care to avoid injury;
- ⑧ This grinder is not for children, please keep them away;
- ⑨ The grinder is a precision device. If you need to disassemble the burrs or related components, please contact customer service or seek guidance from a professional. MHW-3BOMBER is not responsible for any damage caused by unauthorized disassembly;
- ⑩ If the power cord is damaged, stop using it immediately. Only use the original power cord or one recommended by the manufacturer for replacement.

TROUBLESHOOTING

Error Code	Description	Solution
E1	Speed lower than 100 RPM	Restart the machine
E2	Motor Stall	Adjust to a coarser grind or higher speed, then restart the machine

* When grinding light roasted coffee beans, set the speed to >1000 RPM.

* For any of the issues above or other concerns, please contact MHW-3BOMBER customer service for assistance.

INFORMATION

Brand	 MHW-3BOMBER®	Rated Power	400W
Name	F74 Navigator Electric Grinder	Rated Frequency	50Hz/60Hz
Dimensions(L×W×H)	325mm×109mm×284mm	Bean Hopper Capacity	approx. 50g
Net Weight	7.4kg	Dosing Cup Capacity	approx. 50g
Rated Voltage	220V~/220-240V~/120V~	Warranty	One Year

WARRANTY CARD

Thanks for purchasing MHW-3BOMBER products.

With this warranty card, it can enjoy free maintenance service for 1 year from the date of purchase if the product is not disassembled or damaged artificially.

WARRANTY RULES

THE FOLLOWING CONDITIONS DO NOT BELONG TO THE SCOPE OF FREE WARRANTY:

- ①. Damage caused by human factors such as operation, maintenance, storage and self-disassembly not in accordance with the instruction;
- ②. Damage caused by improper operations or accidents (falling, etc.);
- ③. Damage caused by force majeure factors (such as lightning, earthquake, fire, flood, etc.).

MAINTENANCE INFORMATION

Product name and model _____

Purchase time _____

Purchase methods _____

Order number _____

Customer name _____

Customer contact information _____

Return reason _____

POST-SALE SERVICE REGISTRATION

☐ Maintenance ☐ Change ☐ Return

CERTIFICATION

THIS DEVICE MEETS QUALITY STANDARDS ACCORDINGLY

TEL: 400-9922-092

QA: _____



MAINTENANCE RECORD

Maintenance date	Fault condition	Maintenance result

ABOUT US

Based on excellent coffee aesthetics, we always improve and innovate our products for better performance.

Every product is inspired from coffee and life.

Professionalism is only the foundation, and the transmission of positive energy is actually our pursuit.

IF YOU HAVE ANY QUESTIONS, PLEASE CONTACT US

MHW-3BOMBER Coffee Equipment Manufacturing
(Zhongshan) Co., Ltd.

No.3 Youcheng Road, Baofeng Community,
Xiaolan Town, Zhongshan City

400-9922-092

WWW.MHW3BOMBER.COM



Instagram